

FOR OFF ROAD/RACE USE ONLY!



Driven TT Rearsets for 11-15 Aprilia RSV 4 (APRC ONLY)

Part#: DRP-719

INSTALLATION INSTRUCTIONS

Removal

Shifter Side

1. Remove shift rod from APRC unit.
2. Remove frame plate including stock shift lever from bike.

Brake Side

1. Remove exhaust bolt.
2. Remove 2 m6 bolts holding heal guard.
3. Remove frame bracket.
4. Remove master cylinder plunger pin from brake pedal.
5. Remove rear brake switch and disconnect it from bike.

THE USE OF BLUE LOCTITE IS REQUIRED ON ALL MOUNTING HARDWARE!

Installation

NOTE: ALL PIVOT POINTS MUST BE TIGHTENED USING BLUE LOCTITE AND AN IMPACT GUN.

Shifter Side

1. Install foot peg in frame bracket.
2. Connect driven shift rod to APRC system.
3. Reconnect shift rod into shift pedal.
4. Install frame bracket onto bike.
5. Adjust lever to desired position.
6. For reverse shift move heim joint to the top of the shift lever and adjust lever to desired height. (if more adjustment is needed rotate shift knuckle 10 degrees)

Brake Side

1. Install foot peg in frame bracket.
2. Connect master cylinder plunger to brake lever using OEM pin.
3. Install frame bracket to bike.
4. Install master cylinder using 2 m6 bolts supplied.
5. Use blue Loctite on all bolts and torque all to required specs.
6. Make sure nothing interfere with proper operation of motorcycle.

TOOLS REQUIRED

- 8mm Open End Wrench
- 5mm Hex Key
- 6mm Hex Key
- 8mm Hex Key
- Needle Nose Pliers
- Screw Driver
- Blue Loctite
- Impact Gun

THIS PRODUCT IS INTENDED TO BE INSTALLED BY A CERTIFIED TECHNICIAN*

FOR OFF ROAD/RACE USE ONLY!

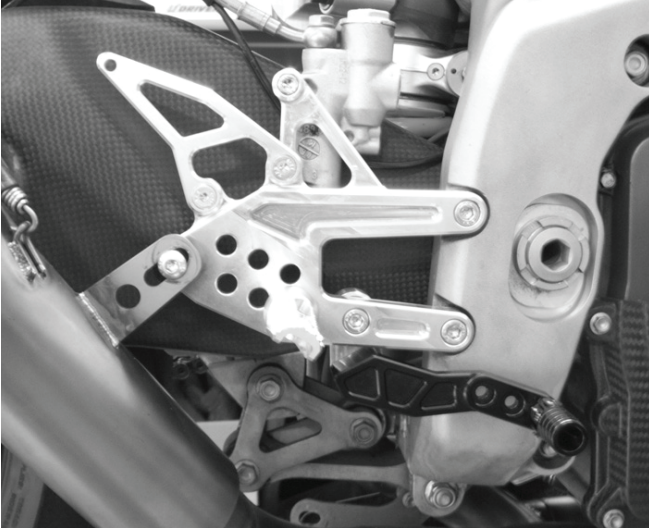

(Fig 1.) Brake

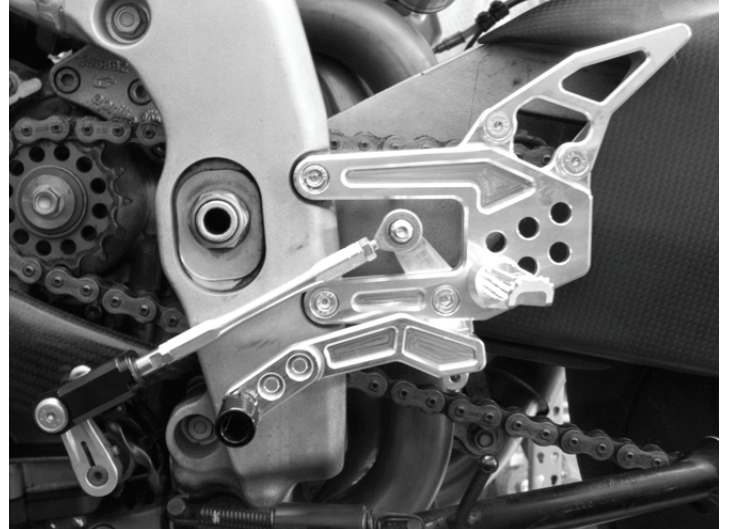

(Fig 2.) Reverse Shift

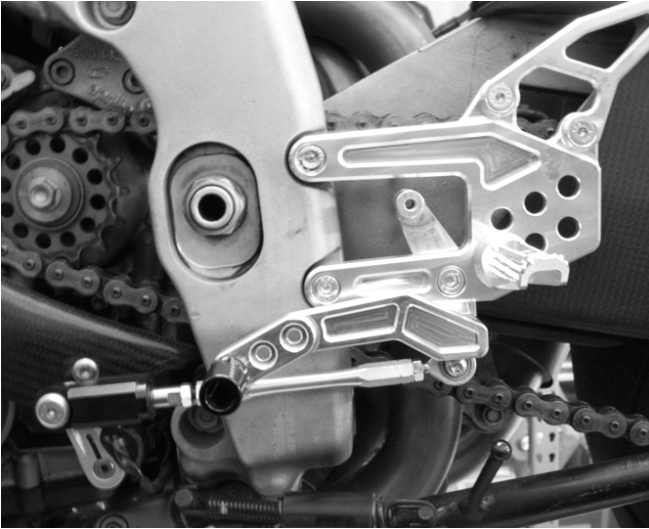

(Fig 3.) Standard Shift

THIS PRODUCT IS INTENDED TO BE INSTALLED BY A CERTIFIED TECHNICIAN*

FOR OFF ROAD/RACE USE ONLY!



Driven TT Rearsets for 11-15 Aprilia RSV 4 (APRC MODELS ONLY)

Part#: DRP-719

**LEFT SIDE / SHIFTER
A00032**

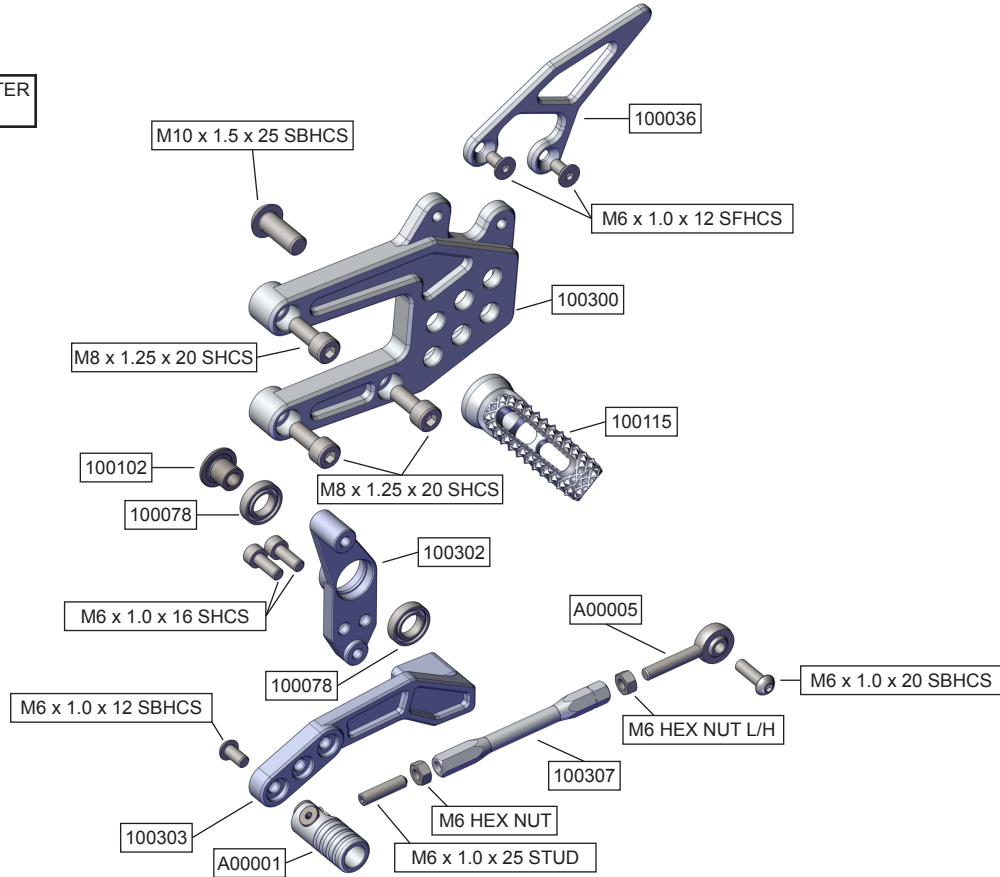

**RIGHT SIDE / BRAKE
A00033**

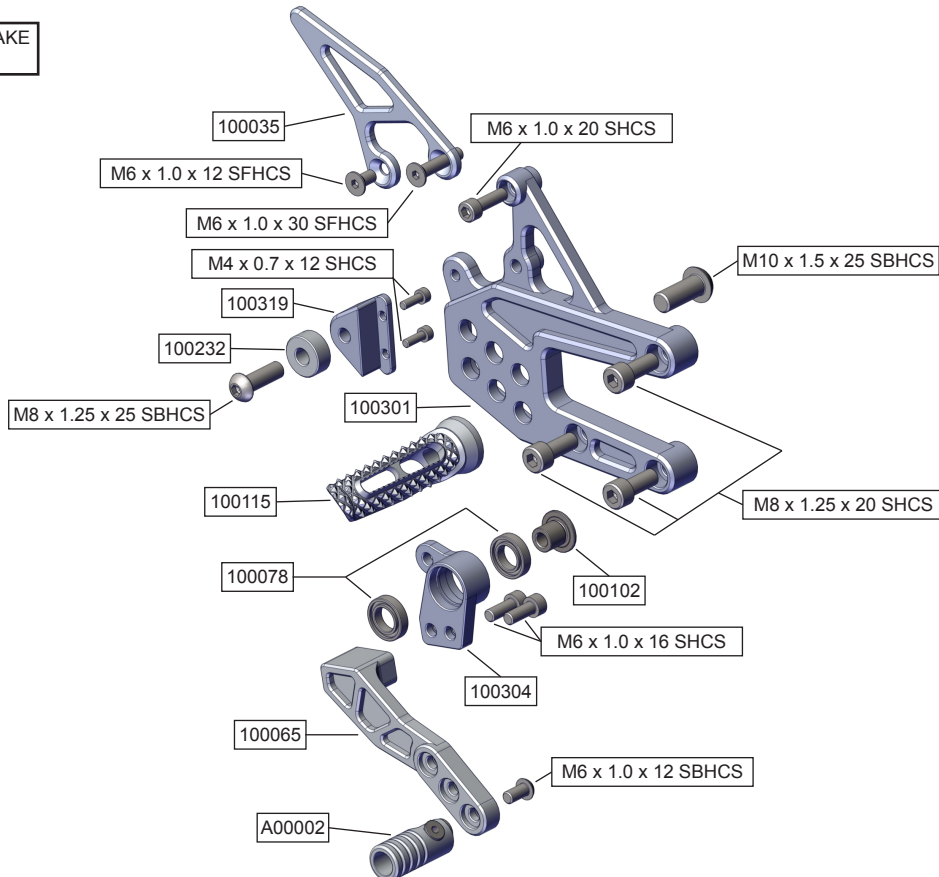

THIS PRODUCT IS INTENDED TO BE INSTALLED BY A CERTIFIED TECHNICIAN*